

INDUSTRIAL LINE

BREAKERMATIC®

ELECTRONIC PROTECTORS FOR AIR CONDITIONERS, ENGINES and REFRIGERATION

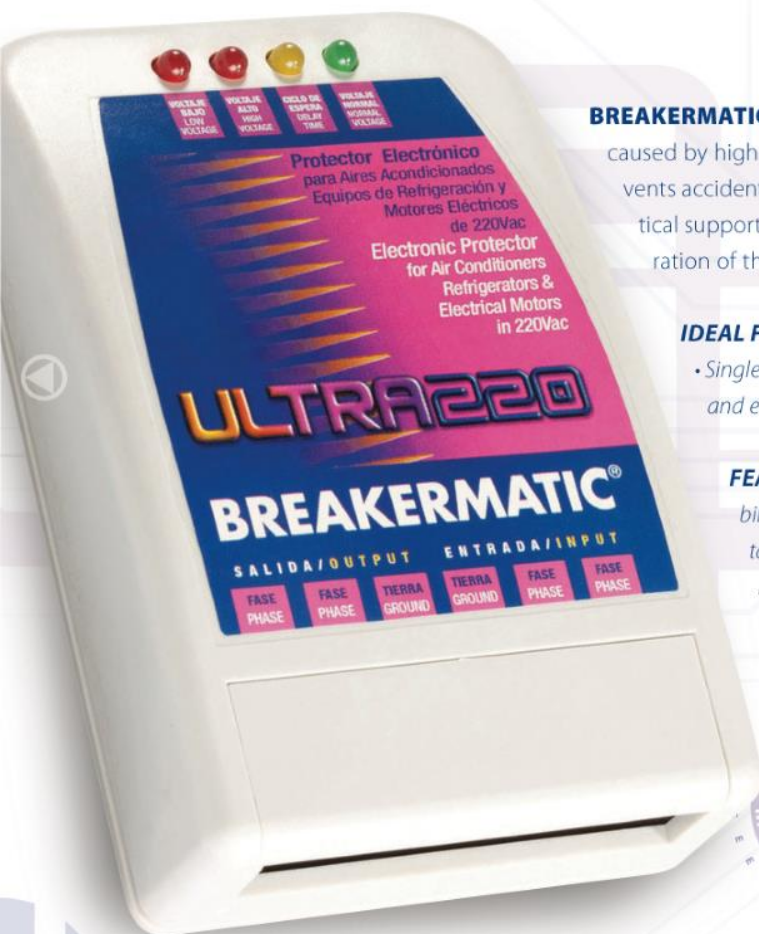

BREAKERMATIC® ULTRA 220, protects your 220V single phase commercial or industrial equipment against damage caused by high voltage, low voltage and blackouts. It is connected by means of a strip covered by a safety cover that prevents accidental contact with the terminals, and it is easily fixed to the wall or to the chassis of the equipment, with a practical support that is supplied with its respective screws and ramplugs. Exclusive Autostart® function that reduces the duration of the waiting cycle if the protector has been disconnected for a certain time.

IDEAL FOR: • Single-phase Air Conditioners • Single-phase 220V Refrigeration Equipment • Showcases and Wine Cellars • Single-phase water pumps • Pools, Jacussis, Whirlpool • Compressors • Single-phase cranes and hoists • Single-phase fans and extractors.

FEATURES: • Protection against: low voltage, high voltage and blackouts • 4 min waiting cycle, which allows the stabilization of the system • Intelligent Autostart® function that reduces the waiting cycle to 5 seconds if the equipment takes more than 10 minutes no power • 4 indicator LEDs that show the status of the protector • Fully automatic operation • Installation: wiring, requires qualified personnel with technical knowledge of electricity.



"Click"
to see

AVAILABLE MODELS / TECHNICAL SPECIFICATIONS

INDUSTRIAL LINE BREAKERMATIC®

ELECTRONIC PROTECTORS FOR AIR CONDITIONERS, ENGINES and REFRIGERATION



BREAKERMATIC® ULTRA 220 / CONNECTION DIAGRAM:

A dry, ventilated place that allows the visualization of the panel of your BREAKERMATIC® equipment and proceed with the installation as indicated below:

1. Assembly:

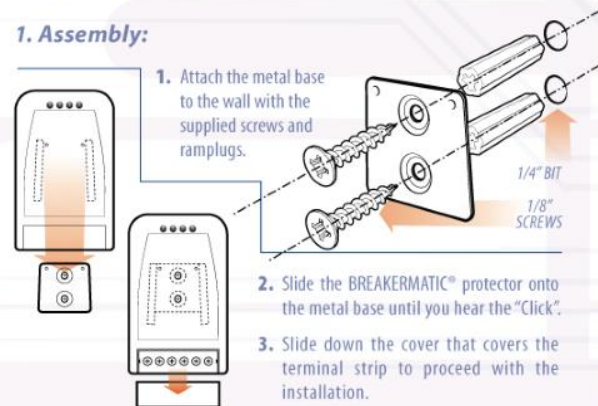

2. Preparation:

"Firmly" attach the supplied terminals to the power cables.



3. Installation:

- Identify the "PHASE" wires coming from the breaker with a voltage tester and connect the wires to the protector connection strip where it says "INPUT".
- Identify the cables that go to the equipment to be protected and connect them where it says "OUTPUT".
NOTE: Use the "GROUND" terminals only if your equipment has three total cables.
- Be sure to place the protective cover on the BREAKERMATIC® protector terminal strip or terminal block.
- Turn on the breaker or fuse switch and your equipment will be automatically protected 24 hours a day.

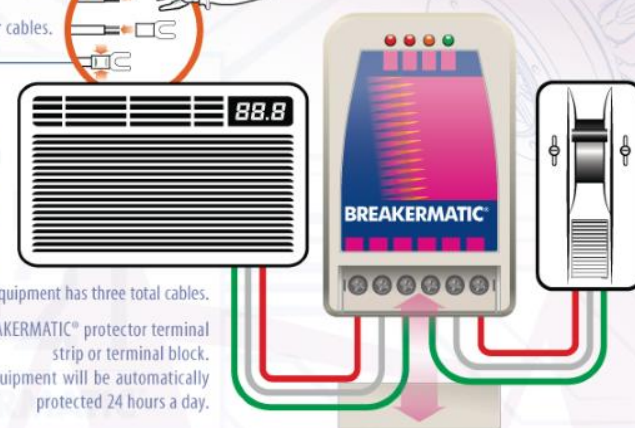

TECHNICAL SPECIFICATIONS:

Distinctive Color in Pack	Model	Code	Nominal Voltage (VAC)	Maximum Current	Maximum Load	Disconnection Voltages	Contact Type	Ignition Delay	Response Time	Autostart*	Switch On/Off	Adjustable Voltage	Weight (g)
Yellow	Ultra 220 "B"	PBE220-B00EST	208 - 220	30A	1½ hp	Low V. Cut-Off: 176 VAC ± 3% / High V. Cut-Off: 253 VAC ± 3%	DRY RELAY	4:00 ± 20%	1,5	YES	NO	NO	300
Red	Ultra 220 "BM"	PBE220-BM0EST	208 - 220	30A	1½ hp	Low V. Cut-Off: 140-210 VAC ± 3% / High V. Cut-Off: 210-278 VAC ± 3% *	DRY RELAY	4:00 ± 20%	1,5	YES	YES	YES	310
Orange	Ultra 220 "A"	PBE220-A00EST	208 - 220	40A	2 hp	Low V. Cut-Off: 176 VAC ± 3% / High V. Cut-Off: 253 VAC ± 3% *	SOLID STATE	4:00 ± 20%	1,5	YES	NO	NO	305
Purple	Ultra 220 "AM"	PBE220-AM0EST	208 - 220	40A	2 hp	Low V. Cut-Off: 140-210 VAC ± 3% / High V. Cut-Off: 210-278 VAC ± 3% *	SOLID STATE	4:00 ± 20%	1,5	YES	YES	YES	310
Green	Ultra 220 "AT"	PBE220-AT0EST	208 - 220	40A	2 hp	Low V. Cut-Off: 140-210 VAC ± 3% / High V. Cut-Off: 210-278 VAC ± 3% *	SOLID STATE	1:50-4:50 ± 20% *	2,5	NO	NO	YES	310
Frecuencia: 50/60Hz.			Input Connection: 3-Contact Terminal Block			Output Connection: 3-Contact Terminal Block			Dimensions (mm): 139 x 87 x 40				

(*) Adjustable.

return