

INDUSTRIAL LINE

BREAKERMATIC®

ELECTRONIC PROTECTORS FOR AIR CONDITIONERS, ENGINES and REFRIGERATION

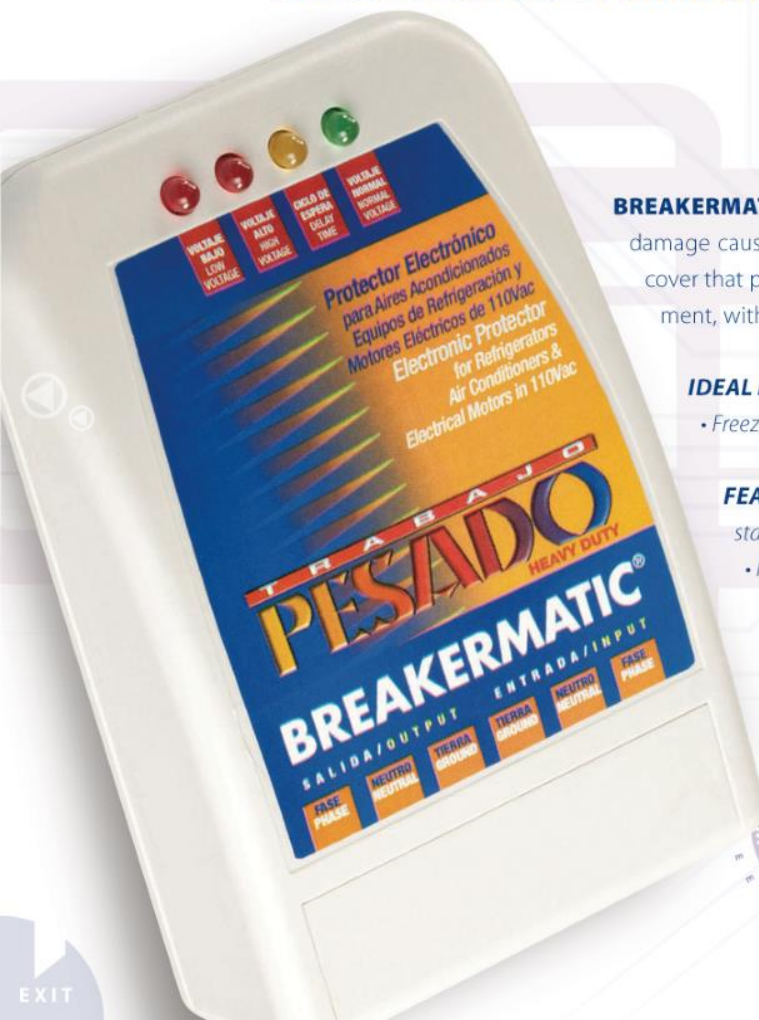

BREAKERMATIC® TRABAJO PESADO, protects your 120VAC single phase commercial or industrial equipment from damage caused by high voltages, low voltages and blackouts. It is connected by means of a strip covered by a safety cover that prevents accidental contact with the terminals, and it is easily fixed to the wall or to the chassis of the equipment, with a practical support that is supplied with its respective screws and ramplugs.

IDEAL FOR: • Air conditioning equipment • Commercial displays, refrigerators and showcases • High capacity equipment • Freezers • Refreshments, bottle racks and slush machines • Cold rooms • Water pumps • Electric Gates.

FEATURES: • Protection against: low voltage, high voltage and blackouts • Standby cycle of 4 min. that allows the stabilization of the system • 4 indicator LEDs to indicate the status of the protector • Fully automatic operation • Installation: wired, requires a qualified electrician or technician.



"Click"
to see

AVAILABLE MODELS / TECHNICAL SPECIFICATIONS

INDUSTRIAL LINE

BREAKERMATIC®

ELECTRONIC PROTECTORS FOR AIR CONDITIONERS, ENGINES and REFRIGERATION

BREAKERMATIC® TRABAJO PESADO / CONNECTION DIAGRAM:

A dry, ventilated place that allows the visualization of the panel of your BREAKERMATIC® equipment and proceed with the installation as indicated below:

1. Assembly:

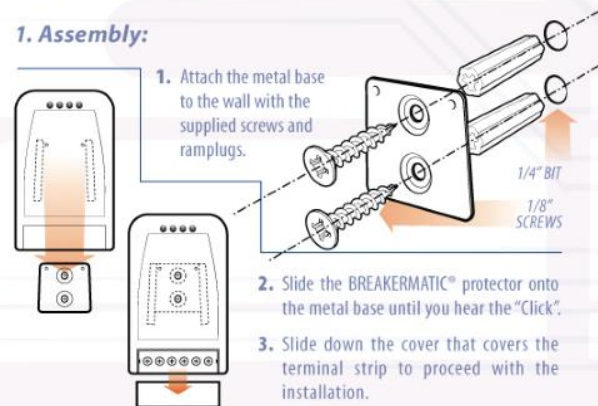

2. Preparation:

"Firmly" attach the supplied terminals to the power cables.

3. Installation:

- Identify the "PHASE" wires coming from the breaker with a voltage tester and connect the wires to the protector connection strip where it says "INPUT".
- Identify the cables that go to the equipment to be protected and connect them where it says "OUTPUT".
NOTE: Use the "GROUND" terminals only if your equipment has three total cables.
- Be sure to place the protective cover on the BREAKERMATIC® protector terminal strip or terminal block.
- Turn on the breaker or fuse switch and your equipment will be automatically protected 24 hours a day.

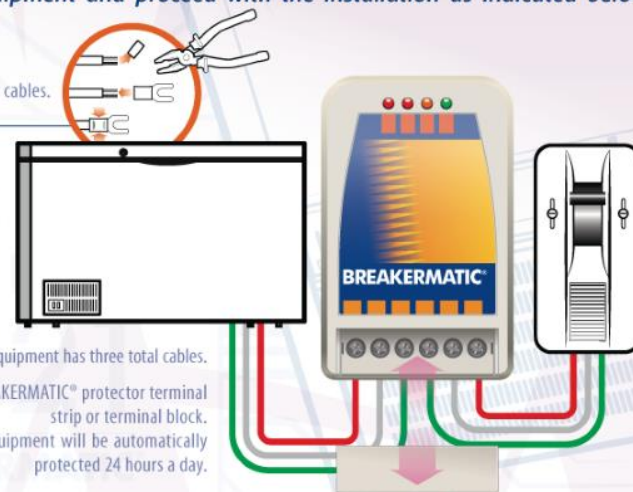

TECHNICAL SPECIFICATIONS:

Code	Nominal Voltage (VAC)	Maximum Current	Maximum Load	Disconnection Voltages	Contact Type	Ignition Delay (min / sec)	Response Time (sec)	Switch On/Off	Adjustable Voltage	Weight (g)
PBE110-000EST	120	30A	1 hp	Low V. Cut-Off: 93 VAC \pm 3% / High V. Cut-Off: 140 VAC \pm 3%	DRY RELAY	3:50 \pm 20%	1,5	NO	NO	295
PBE110-M00EST	120	30A	1 hp	Low V. Cut-Off: 80-114 VAC \pm 3% / High V. Cut-Off: 114-150 VAC \pm 3% *	DRY RELAY	3:50 \pm 20%	1,5	YES	YES	295

Frecuencia: 50/60Hz.

Input Connection: 3-Contact Terminal Block

Output Connection: 3-Contact Terminal Block

Dimensions (mm): 139 x 87 x 40

(*) Adjustable.

return